

HERMETIC GAS WATER HEATER

USER AND INSTALLATION MANUAL 25-12 Lw / 28-12 Lw





Our dear customer;

Thank you for choosing our product and we wish you to use your device in good times. We want you to get the best out of your product. For this reason, we recommend that you read this manual carefully before you start using your product and keep it with the device as a reference for future reference.

This guide will help you use your device more efficiently and safely. For this reason, pay attention to the items we have mentioned below.

- Before using and operating the product, be sure to read the user manual.
- Follow the information and rules we provide regarding safe use.
- Please note that the user manual may also apply to other models. The differences between the models are clearly stated in the manual.

CAUTION

Before assembling the device, on the page in the user manual;

- Assembly instruction
- Electrical connection warnings
- Read the warnings and information titled Matters needing attention.

The device is out of warranty due to installation and electrical connections made without paying attention to the relevant instructions, warnings and information.



IMPORTANT

SAFETY AND WARNINGS

- Only authorized services should work on the product.
- In case of misuse or improper use; may be life-threatening, and material damage may occur to the product or its surroundings.
- This product is intended as a hot water preparation and heating device for closed heating systems.

Intended use

- Consideration of the operating, installation and maintenance manuals supplied with the product and other components of the system.
- Installation and assembly of the product and system according to the assembly rules
- It is the fulfillment of all control and maintenance conditions in the manuals.
- Not suitable for any use other than or exceeding those described in this manual.
- Any direct commercial and industrial use is not suitable for its intended use.

Attention!

Any kind of malicious use is prohibited.

Before starting to work on the product;

- Turn the product off by turning off all power supplies.
- Check that there is no voltage Wait at least 2 minutes until the entire load is discharged.
- There is a risk of death from electric shock if you touch live components, care must be taken.

Before starting to work on the product;

- Turn the product unloaded by turning off all power supply.
- Check that there is no voltage Wait at least 2 minutes until the entire load is discharged.
- There is a risk of death from electric shock if you touch live components, care must be taken.
- Do not place objects or other objects on the device.



Assembly

- Use suitable tools for tightening or loosening union connections.
- Sprays, solvents, cleaning agents containing chlorine, paints, adhesives, ammonia compounds, powders, etc. substances can cause corrosion of the product.
- It should be ensured that chemical substances are not stored at the installation site.
- It is not suitable for installation in wet and humid environments.
- Applicable National instructions, standards, directives and laws, regulations must be taken into account in the selection and assembly of the assembly site.
- Install the necessary safety devices for the system.
- The cable cross-sections to be used in the assembly part of the booklet must be complied with.
- Appropriate voltage energy voltage specified in the manual should be used for the combi.
- Ensure that the voltage-energy coming to the combi is not variable, intermittent or fluctuating.
- The product should only be installed indoors.
- The installation location should be chosen in accordance with the line layout (water inlet and outlet).
- The product should not be installed near stairwells, emergency exits or air conditioning systems.
- The product should not be mounted on a device whose use would cause product damage. (for example, on a stove with an oil steam or water vapor outlet).
- The product should not be installed in areas where there is a risk of water inlet and flooding.
- Do not install the product in places where there is a danger of freezing.
- Connect the grounding cable to the product's grounding connection and to the appropriate grounding connection of the home installation, this way you will avoid short circuits to the product (eg due to water ingress).
- Be careful when using it at a sleeping place.
- Before the device is installed, the heating and hot water installations must be ready. The installation must have been designed, approved and made by an authorized engineering office. The expenses of all these operations belong to the user.
- Do not keep any objects, materials or other devices that may damage the device, or that may be damaged by the installation connections of the device, under, above or next to the location where the device is mounted.



Fault

- You can find the Fault information titles on the screen in the user manual.
- If a fault occurs in the product, you can see it with a fault description on the screen.
- By looking at the fault information in the manual, you can try to correct the fault with guidance.
- If it is not possible to fix the fault, you can call Thermodynamic customer service.
- Take care to have a general inspection and maintenance every year. You may need to determine the frequency of your maintenance period depending on the results of the inspection. Maintenance operations must be done by Termodinamik Authorized Sales points.
- We recommend using original Termodinamik parts during maintenance or repair work.
- Have the necessary electrical installation prepared for the combi, but do not connect electricity in any way. Only Authorized Person is authorized to make the electrical connection of the device.
- After the assembly is completed and the device is ready for commissioning, make sure to have the device commissioned by the Authorized person.
- The strength of the wall on which the device will be mounted must be able to support the weight of the device. The wall should be thick enough.
- Your device must be mounted on a fireproof wall. If the wall is made of combustible material, the hanging surface points must be well protected with non-combustible material.

Important information

- Please pay attention to the information in the manual about water hardness.
- Take care to have a filter in the installation line.
- Make sure that your installation pump connection is on the installation return line.

Fault

- You can find the Fault information titles on the screen in the user manual.
- If a fault occurs in the product, you can see it with a fault description on the screen.
- By looking at the fault information in the manual, you can try to correct the fault with guidance.
- If it is not possible to fix the fault, you can call Thermodynamic customer service.
- Take care to have a general inspection and maintenance every year. You may need to determine the frequency of your maintenance period depending on the results of the inspection. Maintenance operations must be done by Termodinamik Authorized Sales points.
- We recommend using original Termodinamik parts during maintenance or repair work.
- Have the necessary electrical installation prepared for the combi, but do not connect electricity in any way. Only Authorized Person is authorized to make the electrical connection of the device.
- After the assembly is completed and the device is ready for commissioning, make sure to have the device commissioned by the Authorized person.
- The strength of the wall on which the device will be mounted must be able to support the weight of the device. The wall should be thick enough.
- Your device must be mounted on a fireproof wall. If the wall is made of combustible material, the hanging surface points must be well protected with non-combustible material.

Important information

- Please pay attention to the information in the manual about water hardness.
- Take care to have a filter in the installation line.
- Make sure that your installation pump connection is on the installation return line.

TECHNICAL SPECIFICATIONS

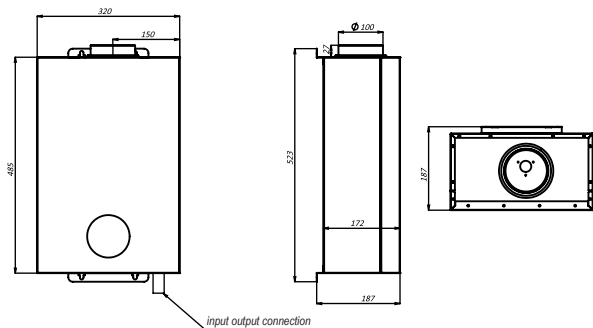

Model	JSG 25-12K	JSG 28-12K
Useful Heat Load (Max)	22kW	28 kW
Useful Heat Load (Min)	8,6kW	9 57 kW
Gas Category	I2H I3B/P	I2H, I2E, I2E+, I3 B/P, I3+
Ignition Type	Automatic Electronic	Automatic Electronic
Gas Pressure	G20;20mbarG30;30mbar	G20 (20 mbar) G30 (30 mbar) G31 (37 mbar)
Chimney Type	Hermetic (c12,c42)	Hermetic (C12, C42)
Control Type	Water Flow Control	Water Flow Control
Suitable Water Pressure	0.2-6 bar	0 2-8 bar
Chimney Pipe	Ø 60 (Exhaust) Ø100 (Input Air)	Ø 60 (Exhaust) Ø 100 (Input Air)
Cold Water Input	G1/2"	G1/2"
Hot Water Input	G1/2"	G1/2"
Gas Input	G3/4"	G3/4"
Rated Electric Power	40W	40W
Electrical Connection	AC 220-230 V ~50 Hz	AC 220-230 V~50 Hz
Product Size	512x328x117(mm)	570 x 350 x 118 (mm)

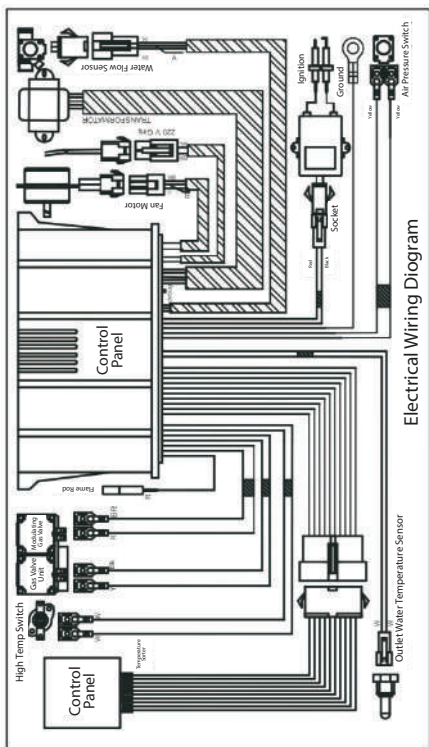
JSG 25-12Lw / JSG 28-12Lw ELECTRICAL WIRING DIAGRAM

JSG-LW TECHNICAL SCHEMATIC

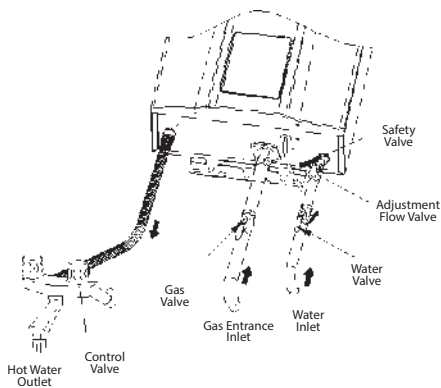
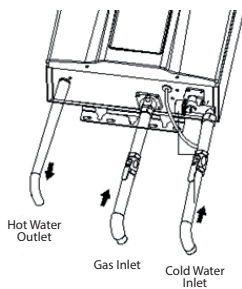
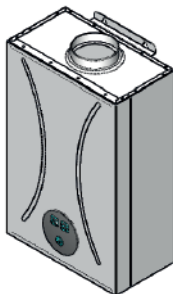
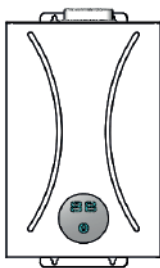

JSG-LW TECHNICAL SCHEMATIC

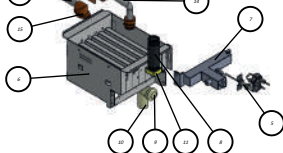
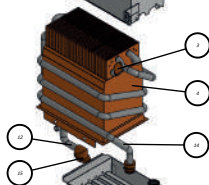
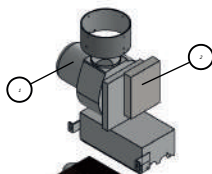
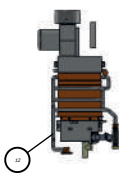
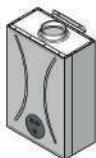
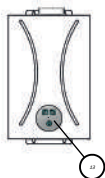
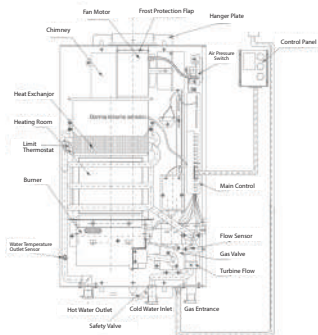
JSG 25-12 Lw INTERNAL STRUCTURE DIAGRAM

resim no	product description
1	fan
2	main controller-QL-HW070
3	limit thermostat
4	Heat exchanger (with connector-inlet&outlet pipe)
5	water heater ionization - ignition plug
6	Burner (with gas manifold)
7	gas manifold
8	water flow senser(with clip)
9	gas valve(with inlet connector)-PCV-10-S01
10	gas valve connector
11	Heat exchanger inlet connector
12	heat exchanger outlet pipe)
13	operation board-QL-TXP222D
14	Heat exchanger (inlet pipe)
15	temp.sensor ntc

JSG 25-12LW

GENERAL INFORMATION

- Constant water temperature; The water temperature can be adjusted easily (35°C - 65°C) by pressing the temperature adjustment button. The electronic control system will adjust the operating level of the device to maintain a constant water temperature.
- Constant water temperature; The water temperature can be adjusted easily (35°C - 65°C) by pressing the temperature adjustment button. The electronic control system will adjust the operating level of the device to maintain a constant water temperature.
- The gas water heater is completely sealed, so 100% of the burned waste gas is thrown out and 100% of the clean air required for combustion is sucked from outside (Hermetic System), the ambient air is not polluted and consumed.
- Automatic working system; When the water valve is opened, the fan will start to run first, followed by automatic ignition.
- Fully automatic water control.

Multiple protection function;

- Overheating: The appliance will stop working when the water temperature is too high or if there is too little water left in the appliance, which may cause dry burning.
- Flame extinguishing safety: If the flame goes out during operation for any reason, the gas flow is automatically cut off.
- Excessive water pressure: When the water pressure is high enough to damage the device, the safety valve will automatically evacuate the excess water.

Frost protection function;

- However, the device has an electronic freeze protection function. When the temperature of the water in the heating system drops below 5°C, the device will automatically switch on to prevent freezing. In order for this function to work, the device's power supply and gas must be turned on, and there must be water in the installation.

The freezing protection function of the device only prevents the existing and waiting water in the water heater and the heat exchanger from freezing. Even if the domestic water is not turned on, when the function is activated, it only heats these parts. It cannot prevent the freezing of your plumbing pipes, city mains water inlet pipes and water heater inlet pipe points. For this reason, in regions where frost is common, assembly and precautionary conditions should be made by considering these issues.



Device; It starts at 4°C, runs for 8 seconds and returns to its initial position.

GENERAL WARNINGS

- The gas type and electricity source specified in this manual must be used in the device.
- The device should be installed in a well-ventilated place.
- In order to prevent carbon monoxide poisoning, use the original flue gas pipe that will allow the waste gas to be evacuated safely to the outside.
- Do not interfere with sealed components.
- Have the device run for the first time only by TERMODİNAMİK AUTHORIZED SERVICES.
- The device must be connected to a 220-230 Volt 50 Hz power supply and the power line must be grounded.
- 2 Ampere Volt automaton protection fuse must be connected so that the phase end is above the fuse.
- A suitable regulator should be used for voltages below 210 V and above 230 V.

GENERAL WARNINGS

- Do not store gasoline or similar flammable liquids and gases near the device.
- In very cold weather, when the inlet water is too cold or the inlet water pressure is too high, the desired high water temperature may not be achieved. This is not a malfunction, it is only necessary to adjust the flow regulating valve and reduce the amount of water inlet to provide the desired water temperature. The low flow rate control valve at normal water temperatures may be another reason for the device to give the E6 error.
- When water flows through the device at a flow rate above the device capacity, the device will continue to operate, however, it will not be able to provide water at the desired temperature and will give an audible warning.
- Do not try to supply hot water to several different places at the same time, otherwise; you get water with little or no hot water.
- In devices working with LPG; Gas cylinders should never be used by tilting, inverting or swinging. Otherwise, malfunctions that may occur will not be covered under warranty. In addition, the tubes to be used must be TSE approved, crushed and crooked pirate tubes should never be used.



- It should not be taken into account that water with a high degree of hardness will cause calcification. Defects and performance degradation caused by calcification,
- The devices are suitable for domestic use. As malfunctions arising from industrial use (restaurant, tea shop, hairdresser, industrial kitchen) force the device to be used beyond its capacity,
- Devices that are not first started by the authorized service,
- Problems arising from the use of water other than utility water (artesian water, waste water, etc.),

It is out of warranty.

- The seller, dealer, agency or representative from which the customer purchased the goods is responsible for the delivery of the warranty certificate to the customer.
- When you buy the product, have your dealer approve the relevant parts of the warranty certificate of our product.
- Device installation should be done by the contractor company. A strainer should be used in the water inlet connection of the device.

When you smell gas;

- Turn off all natural gas appliances and valves, open doors and windows and provide ventilation.
- Turn off the main valve, do not smoke, do not use lighters, matches and fires.
- Do not touch the electrical switches, do not turn the equipment on or off. Do not unplug.
- Do not use and do not use the doorbell. Do not use your phone as there may be sparks.
- Evacuate the gas odor area immediately.
- Do not try to fix the fault yourself.

Symptoms of CO (Carbon Monoxide) poisoning;

Headache, impaired perception, loss of muscle control, weakness, visual disturbance, dizziness, nausea, loss of consciousness.

INSTALLATION OF THE DEVICE

 It is important for the safe and efficient operation of the device and the safety of you and others that the following warnings and recommendations are taken into consideration before the device is installed and first started.

- The first start-up of the device should only be done by AUTHORIZED TERMODİNAMİK SERVICES.
- If natural gas is used, a natural gas installation project must be prepared and approved in accordance with the specifications of local gas distribution companies before the device is installed and gas connection is made. This application should be made by the contracting company.
- How the device works, flue gas discharge connection, etc. THERMODYNAMIC AUTHORITY The warnings of SERVICES must be heeded.
- If the device will work with LPG; LPG connection hoses and fittings must be leakproof. Regulators must be TSE approved. A strainer should be placed at the gas inlet of the device.

 In the use of bulk gas, gas installation and regulator calculated in accordance with the technical specifications of gas companies should be used.

- Make sure you are using the correct type of gas and power source shown on the label.
- When performing future maintenance, make sure there is enough space as shown below for convenience.

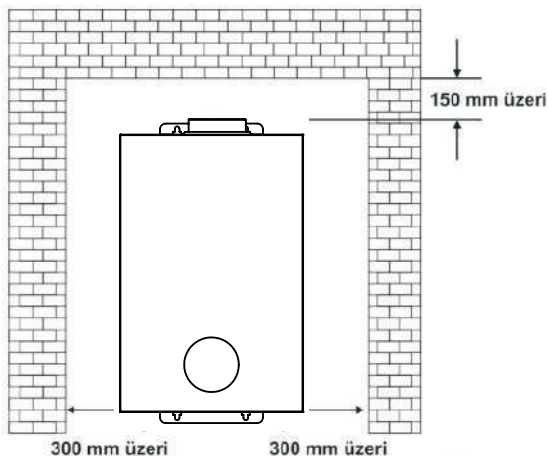

INSTALLATION OF THE DEVICE

- The device must be connected to a 220-230 Volt 50 Hz power supply and the power line must be grounded.
- 2 Ampere Volt automaton protection fuse must be connected so that the phase end is above the fuse. A suitable regulator should be used for voltages below 210 V and above 230 V.
- Try to mount the device on a wall that has no windows around it. (If there is a window, we recommend keeping the distance of the kettle between the upper window or the side window above 600 mm or 150 mm.)
- Make sure that the device is installed away from flammable and explosive materials. The device; Make sure that products that produce steam are not mounted above the gas stove, stove, electrical appliances and under the gas pipe.
- Installation of the device should be done with the Hermetic flue pipe facing out. The hole drilled into the wall for the chimney pipe must be insulated against burning. Hermetic flue pipe should be opened to the outside environment (atmosphere).

Details should be as in the table below (distance A should be over 1500mm).

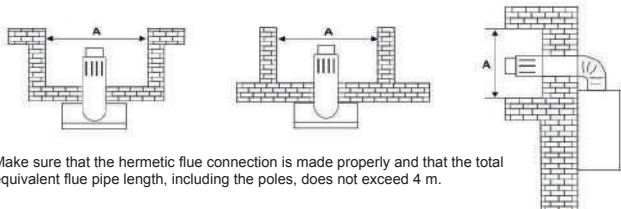

- Make sure that the hermetic flue connection is made properly and that the total equivalent flue pipe length, including the poles, does not exceed 4 m.

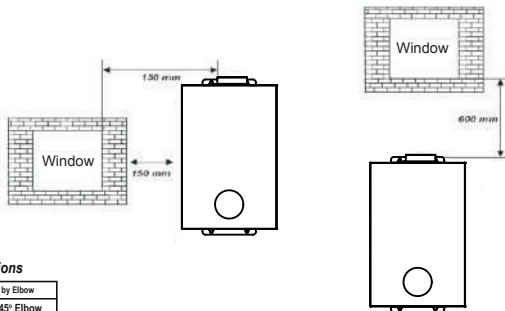

Elbow Dimensions

Line Pipe Shortened by Elbow	
90° Elbow	45° Elbow
1 m	0.5 m

INSTALLATION OF THE DEVICE

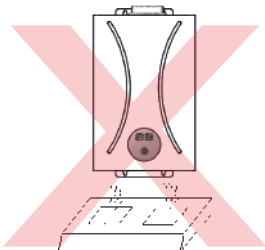
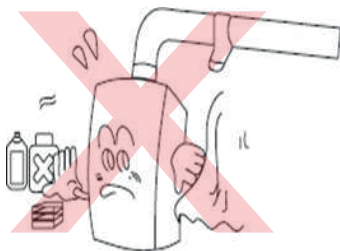
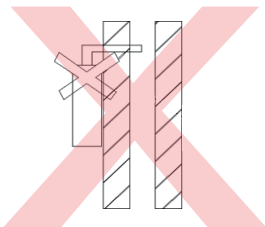
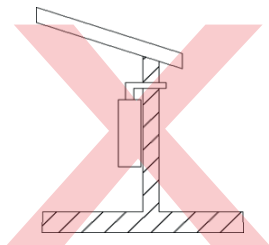

INSTALLATION OF THE DEVICE

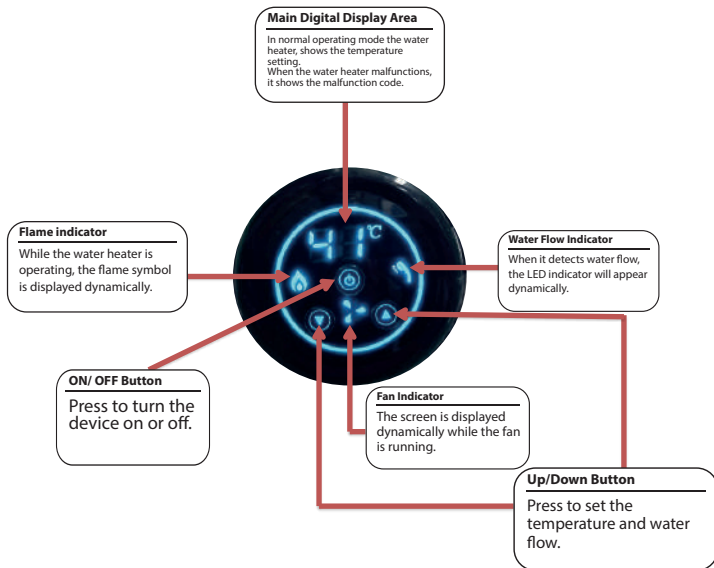



INSTRUCTIONS FOR USE

Indicator content instruction;

Flame indicator

It is a dynamic warning indicator about the return of the flame while the product is operating.

Fan

Fan working dynamic indicator.

°C

Temperature setting indicator.

Main digital display area

In the normal operating mode of the product, it shows the set temperature. When the product fails, it displays the error code.

Touch key instruction

⤴ Up and ⤵ Down Button

For temperature or water flow selection setting.

⏻ ON/OFF Button

It is the on and off button of the water heater.

INSTRUCTIONS FOR USE

Preparation before firing

- After the device is installed; Turn on gas, water and electricity.
- Make sure that the appropriate gas specified on the label is used.
- Plug in and turn on the power
- Open the gas valve

Temperature setting

• On/off "⏻" (On/Off) designed for the water temperature on the screen display on the control panel. Press the button. To set the desired temperature Press Up "⤴" or Down "⤵" button. The lowest hot water temperature for this geyser is 35°C, the highest is 65°C. Press the button once to change every 1°C between 35°C ~ 65°C. Each time you press a key, you will hear the beep.

DEVICE USE

Ignition & Water Output

- Open the water valve;
Make sure that water is getting into the device. Open the fuse connection of the device, the product power light will turn on. The spray signal will appear on the screen. When the fan starts to spin, the igniter turns on and shows flame, depending on them, hot water will come. The display shows the set leaving water temperature.
- When using, the water outlet flow and temperature can be adjusted by the same method as specified. The Digital Display will show the "fan run sign" and the shower sign.
- When the water valve is open but the switch remains in the OFF position, the water heater will stop working and only cold water will flow. If hot water is needed, you should press the ON button.
- When you close the water valve, the heater stops working, but the fan continues to blow into the combustion chamber for a few more seconds. The next time you open the water valve, the product will display the last set temperature.
- After each use of the product, the gas valve must be closed and the AC power supply must be cut off.

Warning:

- ▲ After installation, it may be necessary to try a few times for ignition or to completely blow out the remaining air in the gas pipe for the first use after emptying the gas tank.
- ▲ Although the leaving water temperature changes depending on the length of the pipe and the seasons, the temperature seen on the screen is the set temperature. Therefore, please refer to the actual leaving water temperature.
- ▲ If the hot water flow exceeds the kettle's capacity, the water may not be hot enough. Please reduce the water flow accordingly.
- ▲ Every time the kettle starts up, please pay attention to the set temperature on the display and not rated.
- ▲ To avoid scaling, when using the kettle, you should manually test the water temperature before showering.
- ▲ When the heater stops working, the indicator gives an error code, please close the water valve and open it again. Or press and hold the On/Off button until the device turns off and then turn it on again.
- ▲ If the water heater is still not working properly, please close the gas valve and cut off the power. Re-ignite the device after a few minutes.
- ▲ If there is such a negative situation at the point where the device is deployed against climatic freezing events, the electrical energy and gas line of the device must be open.
- ▲ The device should be able to operate when the frost protection function of the device is activated. This function is activated as long as the gas valve and electrical connection of the device are open and only prevents the possibility of freezing in the heat exchanger within the device. It cannot prevent the freezing of your mains pipe and that line at the water inlet point to your plumbing pipes and water heater. Take care to protect your installation by using different methods for such situations.
- ▲ If the device will not be used for a long time in areas where there is a risk of frost, or if there is an activity problem in the electrical energy and gas coming to the device, be careful not to keep water inside the device or in your installation.

DEVICE USE

Timing protection function (only used with kettle timer protection).

When the water heater continues to work for 20 minutes, the off timer and safety protection notification will be activated. This is a normal situation to remind the user of environmental ventilation. If it is necessary to continue use, close the water valve and open it again.

The fact that the products also work on mobile and mobile vehicles is not considered appropriate by our company for the reasons explained below.

The working environment, external input and installation conditions of our devices for fixed locations are seen and evaluated by the authorized service, and a safe operation approval is given for that environment.

- Affecting the joints of the flue pipe in mobile vehicles due to vibration, thus risking device operation and indoor safety.
- The electronic components and connections inside the device are affected by the vibration, resulting in the need for service.
- The water pressure and electrical equipment required for the device are constantly changing in mobile vehicles, affecting device performance and customer comfort.
- The safety and security working equipment of the device is activated under constant conditions (gas and electricity connection is continuous). The frost protection function is one of these features. Failure to ensure the continuity of these issues in mobile vehicles
- The above-mentioned issues are not suitable for mobile and constantly changing locations.

Problems that may occur in devices installed under these conditions are considered as user error.

GAS CONVERSION

- Device gas conversion should be done by TERMODİNAMİK AUTHORIZED SERVICES.
- In gas conversions, appropriate nozzle changes should be made in the device, and the gas selection from the parameters should be revised.
- In the LPG gas selection, the gas input to the device should be maximum 30mbar.
- In the selection of natural gas, the gas input to the device should be made by selecting the last stage with a maximum of 21 mbar.
- If these changes and selections are made without authorization and control, it will invalidate the warranty application of the device.

CLEANING AND MAINTENANCE



- We recommend that the (paid) periodic maintenance of the device be performed by our TERMODİNAMİK AUTHORIZED SERVICES once a year.
- Please have a monthly check of the vending machine protective fuse to make sure it is working normally.

- Use a soft cloth to clean the outer cover of the device, do not use chemical cleaning liquids.
- Clean the water inlet filter regularly to ensure that there are no blockages that will reduce the water pressure.
- Burner, injector, combustion electrode, heat exchanger, etc. of the device from THERMODİNAMİK AUTHORIZED SERVICES. Have them inspected and cleaned annually.
- If you are not going to use your device for a long time, after draining the water inside, turn off the gas and water valves and turn off the fuse to which the device is connected.

Do not place objects or other objects on the device.

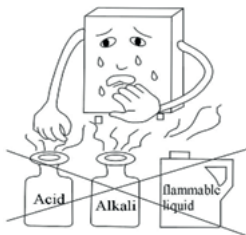
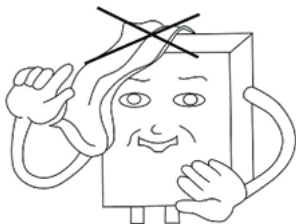



DIGITAL DISPLAY ERROR CODES

During use, the disappearance of fire, wind and other patterns is caused by the activation of the safety device. Flashing of indicator error codes indicates the presence of an action error. The error code flashes when an error occurs. In such cases, turn off the hot water valve and then turn it on or turn off/on the monitor and then operate it 1-2 times. If the indicator still displays the error code, be sure to turn off the water valve and the valve, unplug the power plug and contact the after-sales service.

Error code	Possible Faulty Part or Process	Possible Causes of Error
E0	Leaving Water NTC	There is a problem with the Leaving Water NTC or its connection
E1	Ignition	Sudden ignition failure or extinction of flame. Interruption of gas flow
E2	False Flame	Flame detection before ignition. Checking the electrode and cable connections
E3	Overheat Switch	Activation of the limit thermostat due to excessive temperature
E4	Inlet Water NTC (if any)	There is a problem with the Inlet Water NTC or its connection
E5	Air Pressure	No return signal 8 seconds after the fan's run command or 2 second signal disappears at the time of running
E6	Excessive water temperature	Leaving water temperature rising to ≥ 85 for more than 3 seconds
E7	Gas Valve	Gas valve timed open or short circuit in its connections
En & EE	Scheduler	More than 20 minutes of continuous operation
Ec & Ed	Connection	Interruption of communication between graphics card and motherboard for more than 5 seconds
EA	Freeze Protection NTC	There is a problem with the frost protection NTC or its connection

If the device has malfunctioned for any reason, do not attempt to restart or repair the device yourself. Otherwise, the manufacturer cannot be held responsible for any damages that may arise. In case of malfunction and maintenance, only consult **TERMODİNAMİK AUTHORIZED SERVICE/s**.

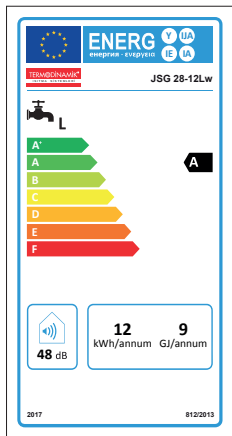
ERP FACT SHEET
JSG 28-12Lw

ENERGY LABEL for JSG 28-12Lw

TERMODİNAMİK JSG 28-12Lw

Energy Efficiency Class: **A**

Sound Power Level: **48 dB**

Energy Consumption: **12 kWh/annum** / **9 GJ/annum**

2017 812/2013

Parameters	Unit	MODEL JSG 28-12Lw
Product Description		Hermetic Water Heater
Ignition Type		Electronic Ignition
Gas Category		12I-JVP
Max Heat Load	cik	28,0
Min Heat Load	cik	9,0
Max Heat Power	kW	25,2
Min Heat Power	kW	7,7
Max Water Pressure	Bar	10
Min Water Pressure	Bar	0,7
Hot Water Production	l/h	14
Hot Water Heating Range	°C	35/50
Chimney Outlet		110, 220
Daily Electricity Consumption	kWh	0,055
Nitrogen Oxide Emissions	mg/kWh	74,62
Declared Load Profile for Water Heating	%	
Water Heating Energy Efficiency Class		A
Energy Efficiency	%	80
Yearly Fuel Consumption	GJ	8,5
Daily Fuel Consumption	kWh	11,448
Yearly Electric Energy Usage	kWh	12
Sound Power Level	dB(A)	48
Gas Inlet Pressure	hPa/20°C, mbar	20
Electrical Connection		4C 220-230V 50Hz
Electricity Consumption	W	50
Measurement		180 x 350 x 210

TERMODİNAMİK MAKİNE SAN. VE TİC. A.Ş.
Kemalpaşa O.S.B. Mah. No: 10 Kemalpaşa / İZMİR / TÜRKİYE

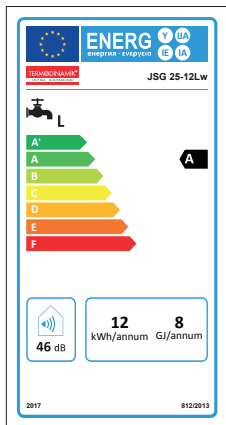
JSG 25-12Lw

Parameters	Unit	MORU JSG 25-12Lw
Product Description		Hermetic Water Heater
Ignition Type		Electronic Ignition
Gas Category		23116/4
Max Heat Load	kw	27.0
Min Heat Load	kw	8.0
Max Heat Power	kw	19.2
Min Heat Power	kw	6.8
Max Water Pressure	Bar	16
Min Water Pressure	Bar	1.2
Hot Water Production	l/h	12
Hot Water Heating Range	°C	20-50
Chimney Outlet		1 x 3. C.15
Daily Electricity Consumption	kWh	0.038
Nitrogen Oxide Emissions	mg/kWh	21.56
Declared Load Profile for Water Heating	%	L
Water Heating Energy Efficiency Class		A
Energy Efficiency	%	50
Yearly Fuel Consumption	G	5.2
Daily Fuel Consumption	kWh	0.128
Yearly Electric Energy Usage	kWh	12
Sound Power Level	dB(A)	46
Gas Inlet Pressure	NO, 23116/4	21
Electrical Connection		AC 220-230V 50/60
Electricity Consumption	Wh	41
Measurement	mm	510 x 320 x 150

TERMODİNAMİK MAKİNE SAN. VE TİC. A.Ş.
 Kemalpaşa O.S.B. Mah. No:10 Kemalpaşa/İZMİR TÜRKİYE

TERMODİNAMİK®
HEATING SYSTEMS

www.termodinamik.com.tr

The brand you trust for years...



/ Termodinamik Isıtma Sistemleri



/ termodinamikisitma



+90 (850) 222 22 35



www.termodinamik.com.tr
iletisim@termodinamik.com.tr



Kemalpaşa O.S.B Mah.
80 Sok. No:10 Kemalpaşa/İZMİR

 **TD Group**
TERMODİNAMİK ŞİRKETLER GRUBU